



Elegant transparency:
Sensys hinge for glass applications



For the perfect marriage of functionality and aesthetic appeal:

Furniture featuring glass elements bring a breath of elegance to any living room. With its narrow bonding surfaces, the Sensys hinge for glass applications creates a perfect purist look. Whether classy glass display cabinets or a modern material combination of wood and glass – the hinge unobtrusively blends into the furniture's overall

appearance. Glue mounting also gives you the supremacy to create fronts that stand out from the crowd.

Needless to say, Sensys for glass applications provides the tried and tested user friendly functions that Sensys has to offer.



Integrated Silent System gently and reliably closes a delicate glass door every time.



Sensys for glass applications combines exquisite design and outstanding performance.



You can very easily combine Sensys for glass applications with all Sensys products.



The practical positioning aid ensures that cup and mounting plate are installed for a perfect fit.



Sensys with integrated Silent System for glass applications
Application summary

2 - 3



Applications with cabinet body side in glass and door in glass

- ▶ overlay door
- ▶ inset door

4 - 7

8 - 9



Applications with cabinet body side in wood and door in glass

- ▶ overlay door
- ▶ inset door

10 - 13

14 - 15



Applications with cabinet body side in glass and door in wood

- ▶ overlay door
- ▶ inset door

16 - 17

18 - 19



Accessories

20 - 24













Technical information

- ▶ Fitting information
- ▶ Installation notes / Quality criteria





25

26 - 28

Applications with cabinet body side and door in glass				
Door position	Opening angle	Application - closed door	Application - opened door	Page
Overlay with door overhang Full overlay Overlay with reveal	135°			4 - 5
Full overlay Overlay with reveal	110°			6 - 7
Inset	110°			8 - 9

Applications with cabinet body side in wood and door in glass				
Door position	Opening angle	Application - closed door	Application - opened door	Page
Full overlay Overlay with reveal	135°			10 - 11
Full overlay Overlay with reveal	110°			12 - 13
Inset	165°			14 - 15

Applications with cabinet body side in glass and door in wood

Door position	Opening angle	Application - closed door	Application - opened door	Page
Full overlay	110°			16 - 17
Inset	110°			18 - 19

Sensys with integrated Silent System for glass applications

- ▶ Cabinet body side glass / door glass, overlay door
- ▶ 135° opening angle



- ▶ Sensys hinge with integrated Silent System, concealed hinge for clip on installation
- ▶ Housing for glue mounting (needed for attaching the hinge to the glass)
- ▶ Mounting plate for glue mounting
- ▶ Glue mounting by means of suitable UV curing adhesive (not included)
- ▶ Quality classification under EN 15570, Level 3
- ▶ For glass thicknesses of 4 – 8 mm
- ▶ Integrated overlay adjustment + 2 mm / - 2 mm
- ▶ Integrated depth adjustment + 3 mm / - 2 mm
- ▶ Integrated height adjustment + 3 mm / - 3 mm

Sensys 8657i for glass applications, opening angle 165°



- ▶ For use with the housing for glue mounting (must be ordered separately)
- ▶ Including screw for attaching
- ▶ Material of hinge arm: nickel plated die-cast zinc / nickel plated steel
- ▶ Material of hinge cup: nickel plated die-cast zinc

Order no.	PU
9 134 989	50 ea.
9 135 140	2 ea.

Housing for glue mounting



- ▶ For use with Sensys 8645i / 8657i for glass applications
- ▶ Bonding surface 28 x 59 mm
- ▶ Die-cast zinc, nickel plated

Order no.	PU
9 116 339	50 ea.
9 116 092	2 ea.

Mounting plate for glue mounting



- ▶ Bonding surface 28 x 74 mm
- ▶ Die-cast zinc, nickel plated

Order no. / Distance D 10 mm	PU
9 133 540	50 ea.
9 133 536	2 ea.

Opening angle limiter for Sensys 8657i



- ▶ Plastic, anthracite

Version	Order no.	PU
Limitation from 165° to 90° or 135°	9 090 864	50 ea.

- ▶ Cabinet body side glass / door glass, overlay door
- ▶ 135° opening angle

Example applications

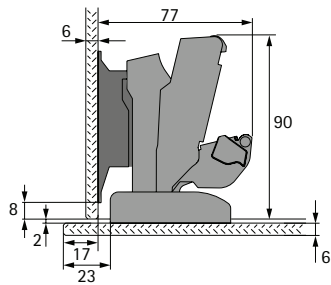

Door overlay with 11 mm door overhang

- ▶ Sensys 8657i for glass applications
- ▶ Housing for glue mounting
- ▶ Mounting plate for glue mounting, distance D 10 mm
- ▶ Opening angle limited to 135°

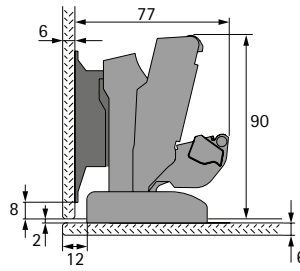

Full overlay door

- ▶ Sensys 8657i for glass applications
- ▶ Housing for glue mounting
- ▶ Mounting plate for glue mounting, distance D 10 mm
- ▶ Opening angle limited to 135°

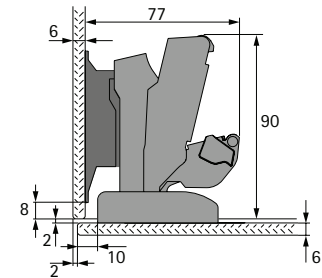

Overlay door with 2 mm reveal

- ▶ Sensys 8657i for glass applications
- ▶ Housing for glue mounting
- ▶ Mounting plate for glue mounting, distance D 10 mm
- ▶ Opening angle limited to 135°

Notes

- ▶ For accessories, see pages 22 – 24
- ▶ For assembly aids, see page 24
- ▶ For technical information, installation notes, see pages 25 – 27

Sensys with integrated Silent System for glass applications



- ▶ Cabinet body side glass / door glass, overlay door, mounting plate on the door
- ▶ 110° opening angle



- ▶ Sensys hinge with integrated Silent System, concealed hinge for clip on installation
- ▶ Housing for glue mounting (needed for attaching the hinge to the glass)
- ▶ Mounting plate for glue mounting
- ▶ Glue mounting by means of suitable UV curing adhesive (not included)
- ▶ Quality classification under EN 15570, Level 3
- ▶ For glass thicknesses of 4 – 8 mm
- ▶ Integrated overlay adjustment + 2 mm / - 2 mm
- ▶ Integrated depth adjustment + 3 mm / - 2 mm
- ▶ Integrated height adjustment + 3 mm / - 3 mm

Sensys 8645i for glass applications, opening angle 110°



- ▶ For use with the housing for glue mounting (must be ordered separately)
- ▶ Including screw for attaching
- ▶ Hinge arm material: steel, nickel plated
- ▶ Material of hinge cup: nickel plated die-cast zinc

Order no.	PU
9 134 990	50 ea.
9 135 141	2 ea.

Housing for glue mounting



- ▶ For use with Sensys 8645i / 8657i for glass applications
- ▶ Bonding surface 28 x 59 mm
- ▶ Die-cast zinc, nickel plated

Order no.	PU
9 116 339	50 ea.
9 116 092	2 ea.

Mounting plate for glue mounting



- ▶ Bonding surface 28 x 74 mm
- ▶ Die-cast zinc, nickel plated

Order no. / Distance D 10 mm	PU
9 133 540	50 ea.
9 133 536	2 ea.

Sensys with integrated Silent System for glass application

- ▶ Cabinet body side glass / door glass, overlay door, mounting plate on the door
- ▶ 110° opening angle

Example applications

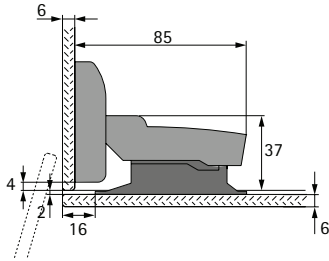

Full overlay door

- ▶ Sensys 8645i for glass applications
- ▶ Housing for glue mounting
- ▶ Mounting plate for glue mounting, distance D 10 mm
- ▶ Mounting plate is fitted on the door, hinge on the cabinet body side
- ▶ Note: On opening, the door moves round next to the cabinet body, please allow for appropriate clearance!

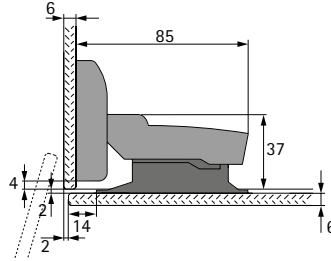

Overlay door with 2 mm reveal

- ▶ Sensys 8645i for glass applications
- ▶ Housing for glue mounting
- ▶ Mounting plate for glue mounting, distance D 10 mm
- ▶ Mounting plate is fitted on the door, hinge on the cabinet body side
- ▶ Note: On opening, the door moves round next to the cabinet body, please allow for appropriate clearance!

Notes

- ▶ For accessories, see pages 22 – 24
- ▶ For assembly aids, see page 24
- ▶ For technical information, installation notes, see pages 25 – 27

Sensys with integrated Silent System for glass applications

- ▶ Cabinet body side glass / door glass, inset door
- ▶ 110° opening angle



- ▶ Sensys hinge with integrated Silent System, concealed hinge for clip on installation
- ▶ Housing for glue mounting (needed for attaching the hinge to the glass)
- ▶ Mounting plate for glue mounting
- ▶ Glue mounting by means of suitable UV curing adhesive (not included)
- ▶ Quality classification under EN 15570, Level 3
- ▶ For glass thicknesses of 4 – 8 mm
- ▶ Integrated overlay adjustment + 2 mm / - 2 mm
- ▶ Integrated depth adjustment + 3 mm / - 2 mm
- ▶ Integrated height adjustment + 3 mm / - 3 mm

Sensys 8645i for glass applications, opening angle 110°



- ▶ For use with the housing for glue mounting (must be ordered separately)
- ▶ Including screw for attaching
- ▶ Hinge arm material: steel, nickel plated
- ▶ Material of hinge cup: nickel plated die-cast zinc

Order no.	PU
9 134 990	50 ea.
9 135 141	2 ea.

Housing for glue mounting



- ▶ For use with Sensys 8645i / 8657i for glass applications
- ▶ Bonding surface 28 x 59 mm
- ▶ Die-cast zinc, nickel plated

Order no.	PU
9 116 339	50 ea.
9 116 092	2 ea.

Mounting plate for glue mounting



- ▶ Bonding surface 28 x 74 mm
- ▶ Die-cast zinc, nickel plated

Order no. / Distance D 10 mm	PU
9 133 540	50 ea.
9 133 536	2 ea.

- ▶ Cabinet body side glass / door glass, inset door
- ▶ 110° opening angle

Example applications

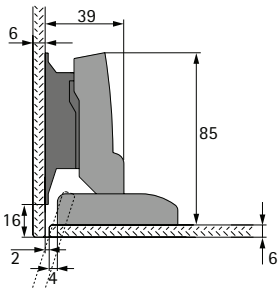

Inset door with 2 mm reveal

- ▶ Sensys 8645i for glass applications
- ▶ Housing for glue mounting
- ▶ Mounting plate for glue mounting, distance D 10 mm

Notes

- ▶ For accessories, see pages 22 – 24
- ▶ For assembly aids, see page 24
- ▶ For technical information, installation notes, see pages 25 – 27

Sensys with integrated Silent System for glass applications

- ▶ Cabinet body side wood / door glass, overlay door
- ▶ 135° opening angle



- ▶ Sensys hinge with integrated Silent System, concealed hinge for clip on installation
- ▶ Housing for glue mounting (needed for attaching the hinge to the glass)
- ▶ Glue mounting by means of suitable UV curing adhesive (not included)
- ▶ Mounting plate from the standard range, e.g. linear mounting plate
- ▶ Quality classification under EN 15570, Level 3
- ▶ For glass thicknesses of 4 – 8 mm
- ▶ Integrated overlay adjustment + 2 mm / - 2 mm
- ▶ Integrated depth adjustment + 3 mm / - 2 mm
- ▶ Integrated height adjustment + 2 mm / - 2 mm

Sensys 8657i for glass applications, opening angle 165°



- ▶ For use with the housing for glue mounting (must be ordered separately)
- ▶ Including screw for attaching
- ▶ Material of hinge arm: nickel plated die-cast zinc / nickel plated steel
- ▶ Material of hinge cup: nickel plated die-cast zinc

Order no.	PU
9 134 989	50 ea.
9 135 140	2 ea.

Housing for glue mounting



- ▶ For use with Sensys 8645i / 8657i for glass applications
- ▶ Bonding surface 28 x 59 mm
- ▶ Die-cast zinc, nickel plated

Order no.	PU
9 116 339	50 ea.
9 116 092	2 ea.

Linear mounting plate for screwing on



- ▶ For 3.5 mm ø x 16 mm countersunk screws
- ▶ Steel, nickel plated
- ▶ Alternatively, a cross mounting plate with distance D 5 mm can be used from the standard range - to select a cross mounting plate, see page 21

Hole line distance LR mm	Order no. / Distance D mm	PU
20	5.0 9 075 097	50 ea.

Opening angle limiter for Sensys 8657i



- ▶ Plastic, anthracite

Version	Order no.	PU
Limitation from 165° to 90° or 135°	9 090 864	50 ea.

- ▶ Cabinet body side wood / door glass, overlay door
- ▶ 135° opening angle

Example applications

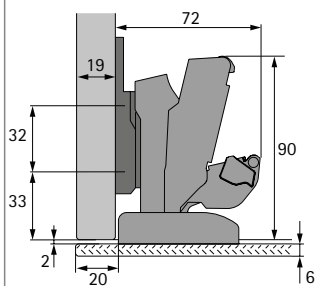

Full overlay door

- ▶ Sensys 8657i for glass applications
- ▶ Housing for glue mounting
- ▶ Linear mounting plate, distance D 5 mm
- ▶ Opening angle limited to 135°

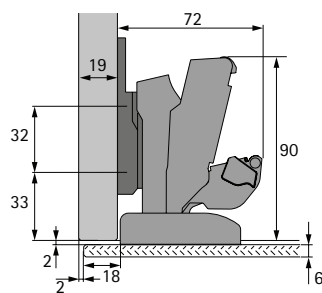

Overlay door with 2 mm reveal

- ▶ Sensys 8657i for glass applications
- ▶ Housing for glue mounting
- ▶ Linear mounting plate, distance D 5 mm
- ▶ Opening angle limited to 135°

Note:

When using an LR37 cross mounting plate, it is screwed into position at a distance of 50 mm from the front edge of the cabinet body

Notes

- ▶ For accessories, see pages 22 – 24
- ▶ For assembly aids, see page 24
- ▶ For technical information, installation notes, see pages 25 – 27

Sensys with integrated Silent System for glass applications

- ▶ Cabinet body side wood / door glass, overlay door, mounting plate on the door
- ▶ 110° opening angle



- ▶ Sensys hinge with integrated Silent System from the standard range, concealed hinge for clip on installation
- ▶ Mounting plate for glue mounting
- ▶ Glue mounting by means of suitable UV curing adhesive (not included)
- ▶ Quality classification under EN 15570, Level 3
- ▶ For glass thicknesses of 4 – 8 mm
- ▶ Integrated overlay adjustment + 2 mm / - 2 mm
- ▶ Integrated depth adjustment + 3 mm / - 2 mm
- ▶ Integrated height adjustment + 3 mm / - 3 mm

Sensys 8645i, hinge base B 3 mm, opening angle 110°



- ▶ Hinge arm material: steel, nickel plated
- ▶ Hinge cup material: steel, nickel plated
- ▶ E.g. cup for screwing on, for other mounting options, see page 21

Cup designation	Drilling pattern mm	Order no.	PU
TH 52	52 x 5.5	9 073 606	50 ea.
TB 52	45 x 9.5	9 073 618	50 ea.
TS 52	48 x 6	9 073 630	50 ea.

Mounting plate for glue mounting



- ▶ Bonding surface 28 x 74 mm
- ▶ Die-cast zinc, nickel plated

Order no. / Distance D 10 mm	PU
9 133 540	50 ea.
9 133 536	2 ea.

- ▶ Cabinet body side wood / door glass, overlay door, mounting plate on the door
- ▶ 110° opening angle

Example applications

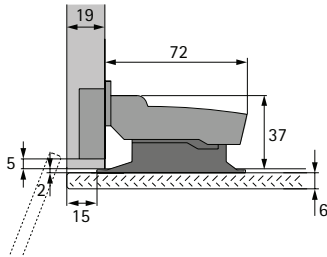

Full overlay door

- ▶ Sensys 8645i, base B 3 mm
- ▶ Mounting plate for glue mounting, distance D 10 mm
- ▶ Mounting plate is fitted on the door, hinge on the cabinet body side
- ▶ Note: On opening, the door moves round next to the cabinet body, please allow for appropriate clearance!

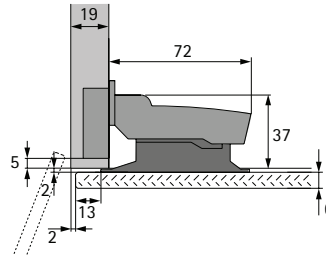

Overlay door with 2 mm reveal

- ▶ Sensys 8645i, base B 3 mm
- ▶ Mounting plate for glue mounting, distance D 10 mm
- ▶ Mounting plate is fitted on the door, hinge on the cabinet body side
- ▶ Note: On opening, the door moves round next to the cabinet body, please allow for appropriate clearance!

Notes

- ▶ For accessories, see pages 22 – 24
- ▶ For assembly aids, see page 24
- ▶ For technical information, installation notes, see pages 25 – 27

Sensys with integrated Silent System for glass applications

- ▶ Cabinet body side wood / door glass, inset door
- ▶ 165° opening angle



- ▶ Sensys hinge with integrated Silent System, concealed hinge for clip on installation
- ▶ Housing for glue mounting (needed for attaching the hinge to the glass)
- ▶ Glue mounting by means of suitable UV curing adhesive (not included)
- ▶ Mounting plate from the standard range
- ▶ Quality classification under EN 15570, Level 3
- ▶ For glass thicknesses of 4 – 8 mm
- ▶ Integrated overlay adjustment + 2 mm / - 2 mm
- ▶ Integrated depth adjustment + 3 mm / - 2 mm
- ▶ Oblong hole height adjustment + 3 mm / - 3 mm

Sensys 8657i for glass applications, opening angle 165°



- ▶ For use with the housing for glue mounting (must be ordered separately)
- ▶ Including screw for attaching
- ▶ Material of hinge arm: nickel plated die-cast zinc / nickel plated steel
- ▶ Material of hinge cup: nickel plated die-cast zinc

Order no.	PU
9 134 989	50 ea.
9 135 140	2 ea.

Housing for glue mounting



- ▶ For use with Sensys 8645i / 8657i for glass applications
- ▶ Bonding surface 28 x 59 mm
- ▶ Die-cast zinc, nickel plated

Order no.	PU
9 116 339	50 ea.
9 116 092	2 ea.

Adapter plate and parallel adapter

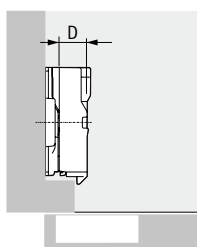

- ▶ Parallel adapter with distance D 8 mm is mounted on the adapter plate with distance D 0 mm in order to achieve the correct distance
- ▶ Parallel adapter, including fixing screw
- ▶ Die-cast zinc, nickel plated
- ▶ E.g. with premounted Euro screws on the adapter plate, for further mounting options, see page 21

Version	Order no.	PU
Adapter plate	9 106 986	50 ea.
Parallel adapter	9 072 537	50 ea.

- ▶ Cabinet body side wood / door glass, inset door
- ▶ 165° opening angle

Example applications

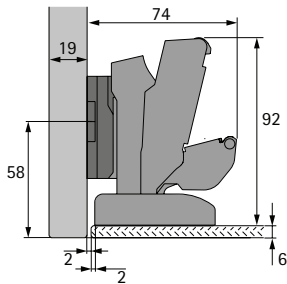

Inset door

- ▶ Sensys 8657i for glass applications
- ▶ Housing for glue mounting
- ▶ Mounting plate, distance D 8 mm

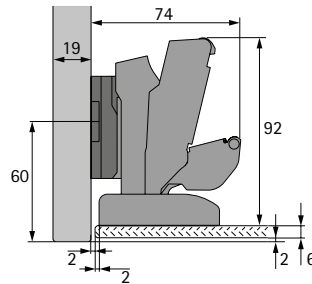

Inset door set back by 2 mm

- ▶ Sensys 8657i for glass applications
- ▶ Housing for glue mounting
- ▶ Mounting plate, distance D 8 mm

Notes

- ▶ For accessories, see pages 22 – 24
- ▶ For assembly aids, see page 24
- ▶ For technical information, installation notes, see pages 25 – 27

Sensys with integrated Silent System for glass applications

- ▶ Cabinet body side glass / door wood, overlay door
- ▶ 110° opening angle



- ▶ Sensys hinge with integrated Silent System from the standard range, concealed hinge for clip on installation
- ▶ Mounting plate for glue mounting
- ▶ Glue mounting by means of suitable UV curing adhesive (not included)
- ▶ Quality classification under EN 15570, Level 3
- ▶ For glass thicknesses of 4 – 8 mm
- ▶ Integrated overlay adjustment + 2 mm / - 2 mm
- ▶ Integrated depth adjustment + 3 mm / - 2 mm
- ▶ Integrated height adjustment + 3 mm / - 3 mm

Sensys 8645i, hinge base B 12.5 mm, opening angle 110°



- ▶ Hinge arm material: steel, nickel plated
- ▶ Hinge cup material: steel, nickel plated
- ▶ E.g. cup for screwing on, for other mounting options, see page 21

Cup designation	Drilling pattern mm	Order no.	PU
TH 52	52 x 5.5	9 073 605	50 ea.
TB 52	45 x 9.5	9 073 617	50 ea.
TS 52	48 x 6	9 073 629	50 ea.

Mounting plate for glue mounting



- ▶ Bonding surface 28 x 74 mm
- ▶ Die-cast zinc, nickel plated

Order no. / Distance D 10 mm	PU
9 133 538	50 ea.
9 133 534	2 ea.

- ▶ Cabinet body side glass / door wood, overlay door
- ▶ 110° opening angle

Example applications

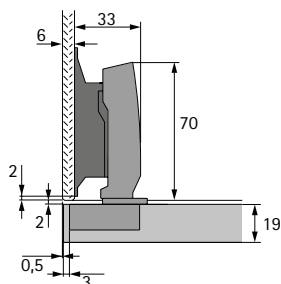

Overlay door

- ▶ Sensys 8645i, base B 12.5 mm
- ▶ Mounting plate for glue mounting, distance D 10 mm

Notes

- ▶ For accessories, see pages 22 – 24
- ▶ For assembly aids, see page 24
- ▶ For technical information, installation notes, see pages 25 – 27

Sensys with integrated Silent System for glass applications

- ▶ Cabinet body side glass / door wood, inset door
- ▶ 110° opening angle



- ▶ Sensys hinge with integrated Silent System from the standard range, concealed hinge for clip on installation
- ▶ Mounting plate for glue mounting
- ▶ Glue mounting by means of suitable UV curing adhesive (not included)
- ▶ Quality classification under EN 15570, Level 3
- ▶ For glass thicknesses of 4 – 8 mm
- ▶ Integrated overlay adjustment + 2 mm / - 2 mm
- ▶ Integrated depth adjustment + 3 mm / - 2 mm
- ▶ Integrated height adjustment + 3 mm / - 3 mm

Sensys 8645i, hinge base B 3 mm, opening angle 110°



- ▶ Hinge arm material: steel, nickel plated
- ▶ Hinge cup material: steel, nickel plated
- ▶ E.g. cup for screwing on, for other mounting options, see page 21

Cup designation	Drilling pattern mm	Order no.	PU
TH 52	52 x 5.5	9 073 606	50 ea.
TB 52	45 x 9.5	9 073 618	50 ea.
TS 52	48 x 6	9 073 630	50 ea.

Mounting plate for glue mounting



- ▶ Bonding surface 28 x 74 mm
- ▶ Die-cast zinc, nickel plated

Order no. / Distance D 10 mm	PU
9 133 540	50 ea.
9 133 536	2 ea.

- ▶ Cabinet body side glass / door wood, inset door
- ▶ 110° opening angle

Example applications

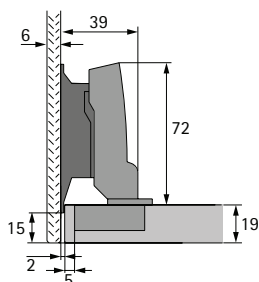

Inset door

- ▶ Sensys 8645i, base B 3 mm
- ▶ Mounting plate for glue mounting, distance D 10 mm

Notes

- ▶ For accessories, see pages 22 – 24
- ▶ For assembly aids, see page 24
- ▶ For technical information, installation notes, see pages 25 – 27

Fast assembly concealed hinge with integrated Silent System



- ▶ Sensys 8645i
- ▶ 110° opening angle



- ▶ Concealed hinge with clip on installation and integrated Silent System
- ▶ Quality classification under EN 15570, Level 3
- ▶ For door thickness of 15 - 24 mm
- ▶ Cup diameter 35 mm
- ▶ Cup depth 12.8 mm
- ▶ Integrated overlay adjustment + 2 mm / - 2 mm
- ▶ Integrated depth adjustment + 3 mm / - 2 mm
- ▶ Height adjustment at mounting plate
- ▶ Hinge arm material: steel, nickel plated
- ▶ Hinge cup material: steel, nickel plated

Sensys 8645i, opening angle 110°

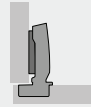
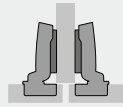
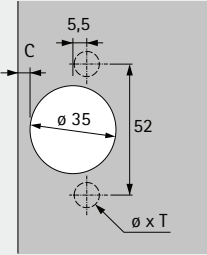
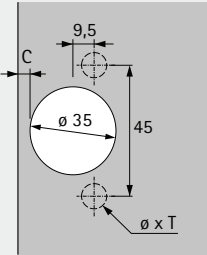
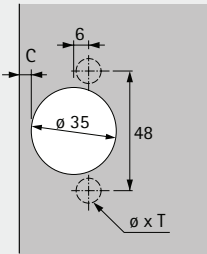
Cup assembly	Drilling pattern	Mounting hole ø x T mm	full overlay	half overlay	PU
					
For screwing on TH 52		-	9 073 605	9 073 606	50 ea.
For pressing in TH 53		ø 10 x 11	9 073 608	9 073 609	50 ea.
Fix fast assembly THS 55		ø 10 x 6	9 073 614	9 073 615	50 ea.
With premounted expanding sockets TH 58		ø 10 x 11	9 073 686	9 073 687	50 ea.
For screwing on TB 52		-	9 073 617	9 073 618	50 ea.
For pressing in TB 53		ø 8 x 11	9 073 620	9 073 621	50 ea.
Fix fast assembly TB 55		ø 8 x 6	9 073 626	9 073 627	50 ea.
With premounted expanding sockets TB 58		ø 8 x 11	9 073 689	9 073 690	50 ea.
For screwing on TS 52		-	9 073 629	9 073 630	50 ea.
For pressing in TS 53		ø 10 x 11	9 073 632	9 073 633	50 ea.
Fix fast assembly THS 55		ø 10 x 6	9 073 614	9 073 615	50 ea.
with premounted expanding sockets TS 58		ø 10 x 11	9 073 692	9 073 693	50 ea.

Fast assembly concealed hinge

- ▶ System 8099 mounting plates with eccentric cam height adjustment
- ▶ For Sensys and Intermat



Cross mounting plate with premounted chipboard screws

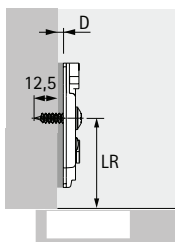

- ▶ For holes with max. \varnothing 2.5 mm
- ▶ Quality classification under EN 15570, Level 3
- ▶ Hole spacing 32 mm
- ▶ Eccentric cam height adjustment \pm 2 mm
- ▶ Steel, nickel plated

Hole line distance LR mm	Order no. / Distance D mm	PU
37	5.0 9 075 088	50 ea.

Cross mounting plate with premounted Euro screws

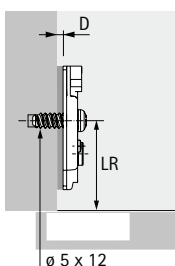

- ▶ For \varnothing 5 x 12 mm holes
- ▶ Quality classification under EN 15570, Level 3
- ▶ Hole spacing 32 mm
- ▶ Eccentric cam height adjustment \pm 2 mm
- ▶ Steel, nickel plated

Hole line distance LR mm	Order no. / Distance D mm	PU
37	5.0 9 075 083	50 ea.

Cross mounting plate with expanding sockets and special screws

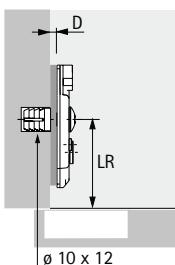

- ▶ For \varnothing 10 x 12 mm holes
- ▶ Quality classification under EN 15570, Level 3
- ▶ Hole spacing 32 mm
- ▶ Cam height adjustment \pm 2 mm
- ▶ Steel, nickel plated

Hole line distance LR mm	Order no. / Distance D mm	PU
37	5.0 9 075 078	50 ea.

Adapter plate for parallel adapter

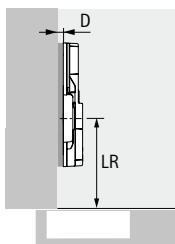

- ▶ For connecting parallel adapters
- ▶ Quality classification under EN 15570, Level 3
- ▶ For use in hole line 28 or 37 mm
- ▶ Can only be used with screwed on adapter
- ▶ Hole spacing 32 mm
- ▶ Oblong hole adjustment \pm 3 mm (version for screwing on / with premounted Euro screws)
- ▶ Oblong hole height adjustment \pm 2 mm (version with expanding sockets)
- ▶ Die-cast zinc, nickel plated

Mounting option	Mounting hole \varnothing x T mm	Order no. / Distance D mm	PU
for screw mounting with \varnothing 4.5 x 16 mm flat head screws	-	0.0 9 106 989	50 ea.
with premounted Euro screws	\varnothing 5 x 12	9 106 986	50 ea.
with expanding sockets	\varnothing 10 x 12	9 106 983	50 ea.

Cover cap for Sensys hinge arm



- ▶ Can be used with Sensys hinges apart from 8657i / 8657 / 8687
- ▶ Cover caps with customised embossed or printed logo on request
- ▶ Steel, nickel plated

Version	Order no.	PU
neutral	9 088 249	50 ea.
embossed with Hettich logo	9 088 250	50 ea.

Cover cap for Sensys zero protrusion hinge



- ▶ Can be used with Sensys hinges 8657i, 8657, 8687
- ▶ Cover caps with customised print available on request
- ▶ Plastic, anthracite

Version	Order no.	PU
neutral	9 099 870	50 ea.
printed with Hettich logo	9 099 871	50 ea.

Cover cap for Sensys hinge cup



- ▶ Can be used for hinges with cup in Sensys design
- ▶ Can be used for all attachment options apart from Fix and premounted wood screw
- ▶ Steel, nickel plated

Version	Order no.	PU
for TH / TS	9 088 251	50 ea.
for TB	9 088 252	50 ea.

Soft opening for Sensys zero protrusion hinge



- ▶ Can be used with Sensys hinge 8657i
- ▶ Cannot be combined with opening angle limiter
- ▶ Plastic, anthracite

Door mounting option	Order no.	PU
full overlay	9 100 037	50 ea.
half overlay	9 100 116	50 ea.

Opening angle limiter for Sensys 8645i



- ▶ For reducing the opening angle of doors with adjoining elements
- ▶ This avoids damaging the front
- ▶ Also suitable for hinges without Silent System / without self closing feature
- ▶ Plastic, white
- ▶ For installation advice, see technical Information

Version	Order no.	PU
Limitation from 110° to 85°	9 072 540	50 ea.

Opening angle limiter for Sensys 8657i



- ▶ For reducing the opening angle of doors with adjoining elements
- ▶ This avoids damaging the front
- ▶ Also suitable for hinges without Silent System / without self closing feature
- ▶ Plastic, anthracite
- ▶ For installation advice, see technical Information

Version	Order no.	PU
Limitation from 165° to 105° or 120°	9 090 756	50 ea.

Opening angle limiter for Sensys 8657i



- ▶ For reducing the opening angle of doors with adjoining elements
- ▶ This avoids damaging the front
- ▶ Also suitable for hinges without Silent System / without self closing feature
- ▶ Plastic, anthracite
- ▶ For installation advice, see technical Information

Version	Order no.	PU
Limitation from 165° to 90° or 135°	9 090 864	50 ea.

Aid for positioning mounting plate for glue mounting



- ▶ For positioning the bonded mounting plate when gluing it in place
- ▶ Required gluing dimension can be adjusted within a range of 2 - 80 mm in increments of 1 millimetre
- ▶ Plastic, anthracite

Order no.	PU
9 227 397	1 ea.

Aid for positioning housing for glue mounting



- ▶ For positioning the bonded housing when gluing it in place
- ▶ Required gluing dimension can be adjusted within a range of 2 - 30 mm in increments of 1 millimetre
- ▶ Plastic, anthracite

Order no.	PU
9 134 988	1 ea.

Number of hinges per door

Door width, height and weight as well as the material quality of the door are decisive factors determining the number of hinges required.

The factors encountered in practice differ widely from case to case. For this reason, the number of hinges specified in the diagram must be understood as a guide only. If in doubt, it is recommended to carry out a trial mounting and adjust the number of hinges as necessary. For reasons of stability, space X between the hinges must always be made as large as possible. Distance X must be at least 280 mm.

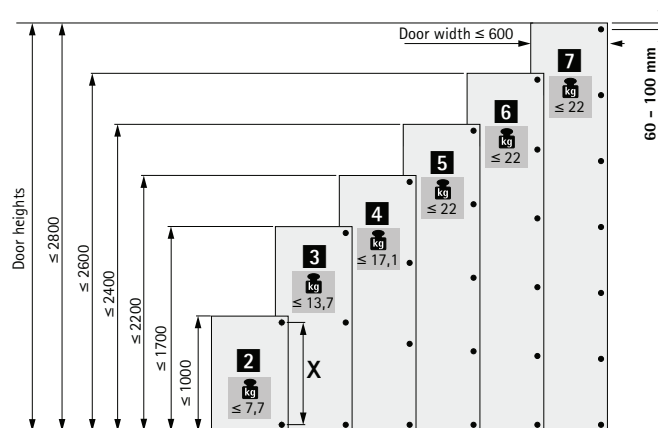

Planning dimensions

Gluing pattern
Housing for glue mounting

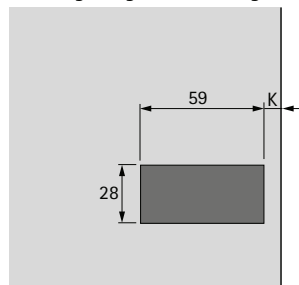

Gluing pattern
Mounting plate for glue mounting

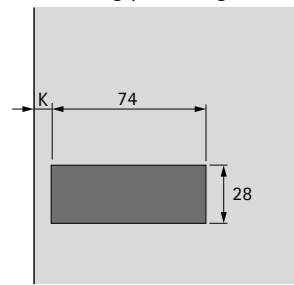

Complexity of bonding

Complexity of bonding

Providing a permanent and therefore secure bond between a fitting and a furniture front depends on numerous factors which are beyond Hettich's control. For this reason, the fabricator must always take into consideration the factors outlined below by way of example.

Variety of materials and surface finishes for furniture fronts

Glass, for example, is among the materials that are bonded in furniture making. However, different glass types can have very different features. For instance, there is glass that is covered with film (in some cases also with mirror film), laminated glass (sometimes with embedded film that lets no UV light through), toughened glass (single pane safety glass) or coloured float glass. The nature of the surface finish also influences the choice of adhesive and gluing method. Examples include textured surfaces, roughened (satinised) or lacquered surfaces.



Defining the adhesive

The choice of adhesive depends on material selected. Often, for example, bonds with glass are made using UV adhesives which harden after exposure to a UV light source. However, it is not always possible to use this form of adhesive owing to the limited light transmissivity of some glass types for example. In such instances, other suitable adhesives, such as two component adhesives, must be used.

Gluing method

Depending on the adhesive chosen, a suitable gluing method must be applied correctly. With bonds made using UV hardening adhesives, for instance, attention must not only be paid to ensuring clean bonding surfaces but also to other factors, such as the distance and radiation field of the UV light source, exposure duration and the temperature of the materials being glued together as well as to the temperature of the surrounding area.

Long term bond stability

Influencing factors, such as temperature, humidity, excessive static or dynamic loads (e.g. from overly heavy doors) can in the long run reduce the stability of a bond. The fabricator must therefore assess the resultant residual risk of a bond failing. Borderline constructions must be avoided.

Conclusion

Given the numerous influencing factors, Hettich is unable to provide any generally binding specification on adhesive and gluing methods. The adapter must be glued to a glass door by a specialised fabricator who must also select an adhesive and gluing method suitable for the door's specific properties.

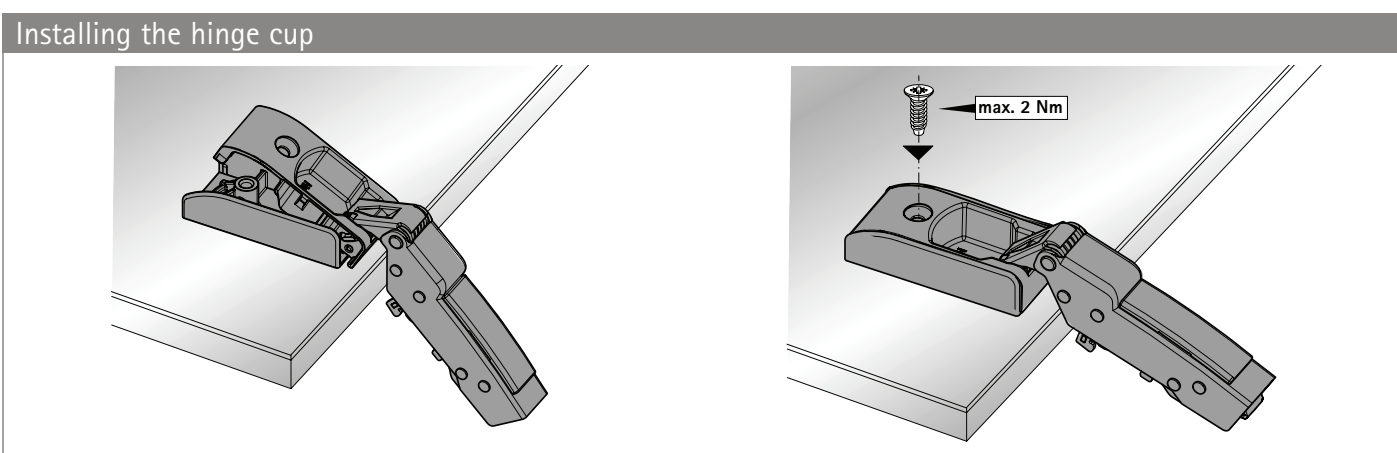
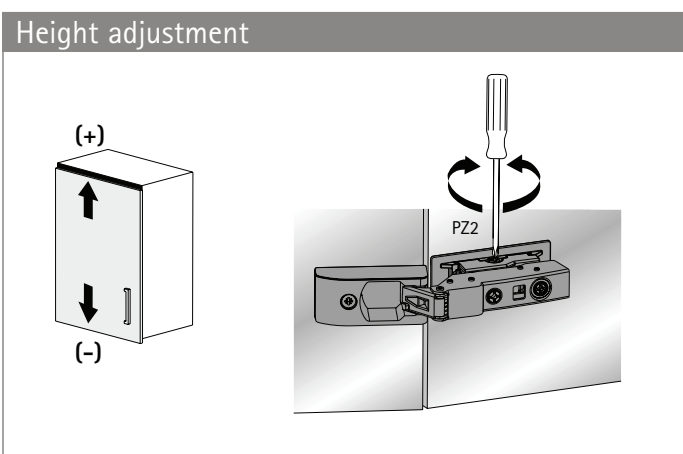
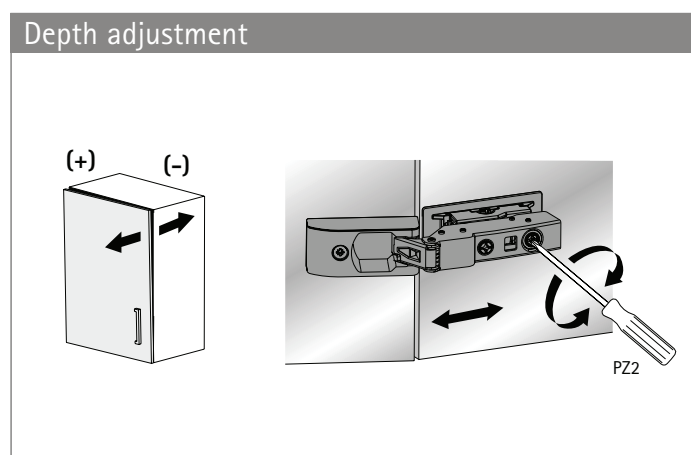
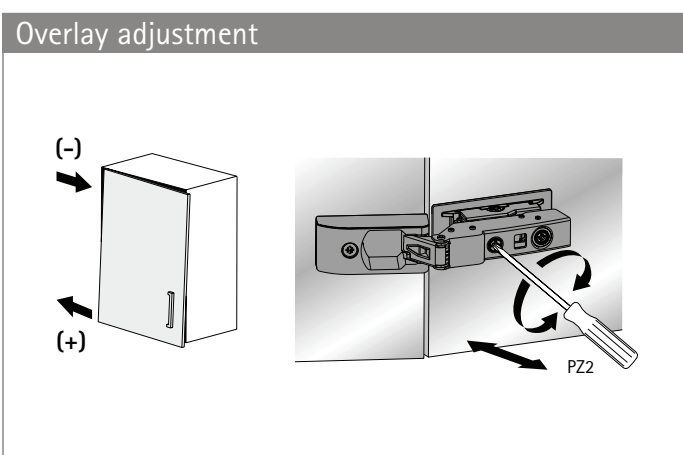
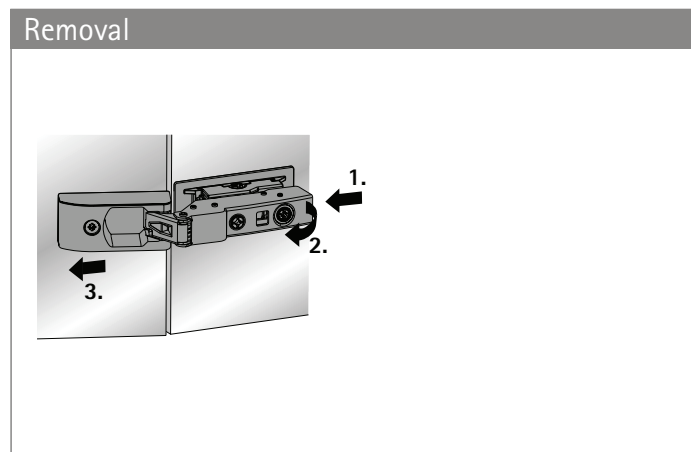
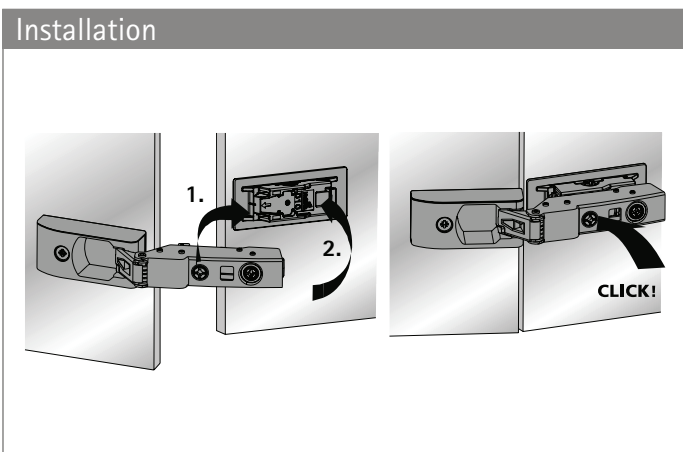

Installing the opening angle limiter for 8657i zero protrusion hinge

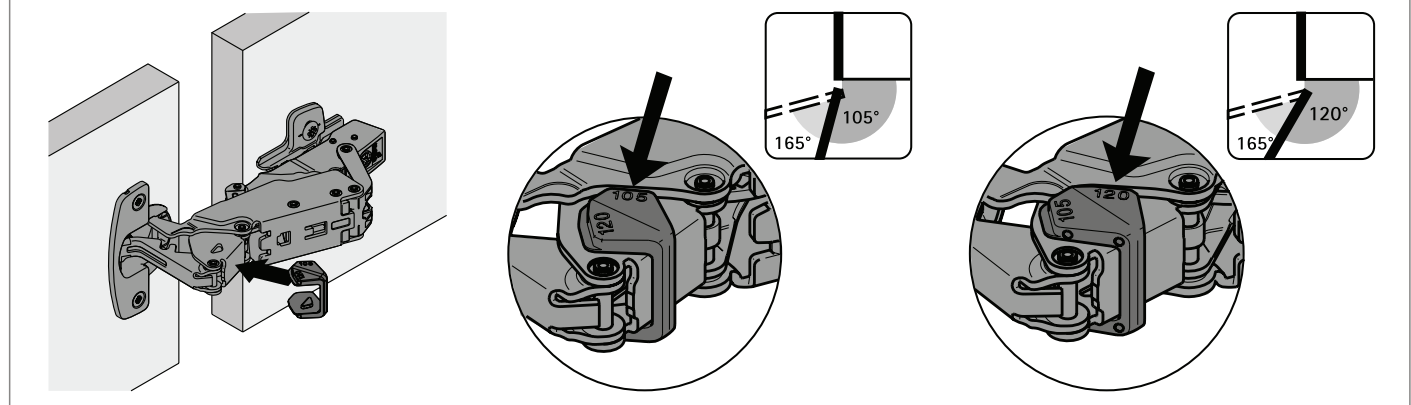

Installing the opening angle limiter for 8657i zero protrusion hinge

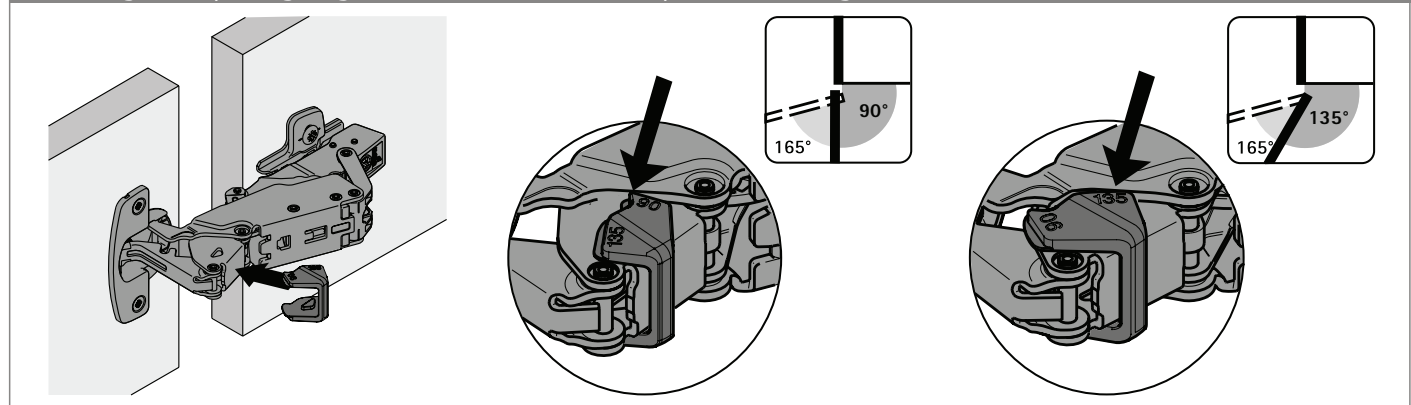

Using screwdriver for installing opening angle limiter for Sensys 8645i, Sensys 8639i W

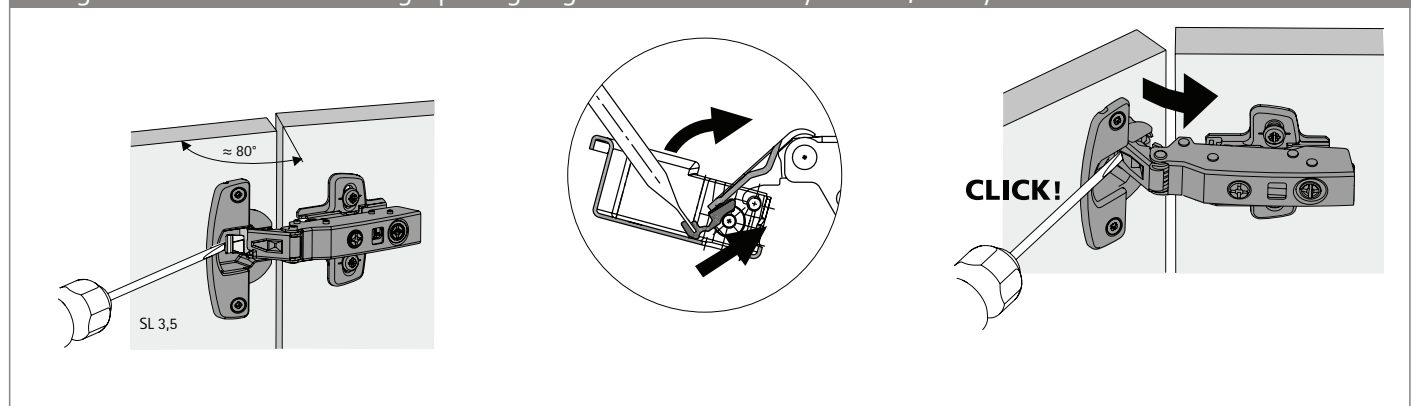

Installing soft opening

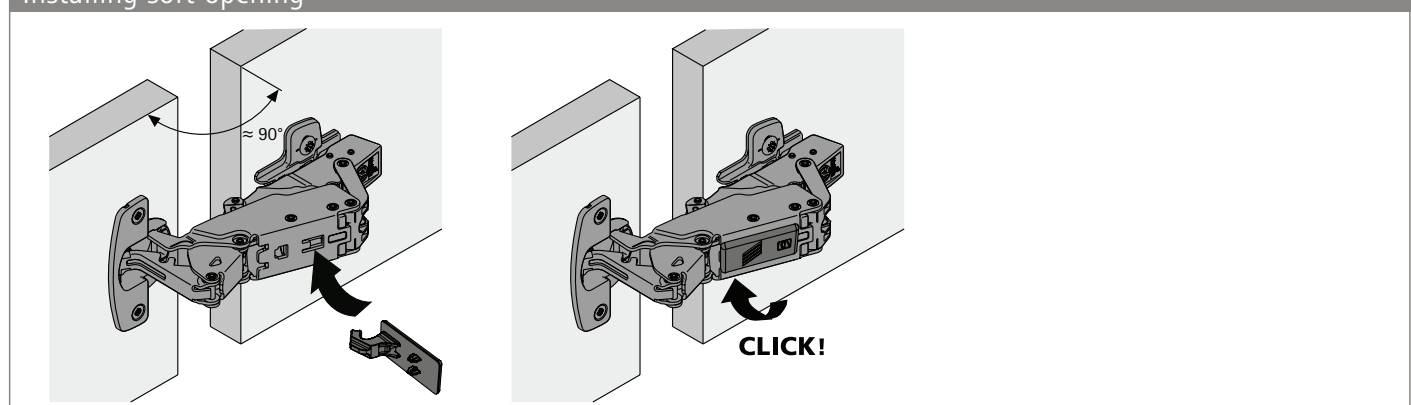

Quality that meets all the demands

Quality that meets all the demands

The quality of hinges is subject to a process of continuous monitoring. Hettich fittings comply with the national and international quality standards of the markets our customers operate in. The diagrams below show examples of the principles behind some of the testing processes.

Application

Hettich hinges can be used in living room, kitchen, bathroom and office furniture.

Load capacity

The quality levels indicated on products comply with the requirements of EN 15570 and satisfy the overload tests at the specified level. We will be pleased to provide any further information you may require.

Corrosion test

Hettich hinges satisfy the corrosion requirements under EN ISO 9227-2012 in accordance with the 48 h neutral salt spray test (NSS) as well as DIN EN ISO 6270-2-2012 in accordance with the 96 h alternating condensation water climate test with alternating air humidity and temperature (AHT).

Quality assurance

The processes for assuring the quality of Hettich hinges are certified under EN ISO 9001, Cert. No. DE8000209.

Endurance test

The door is subjected to a specific number of opening and closing cycles.

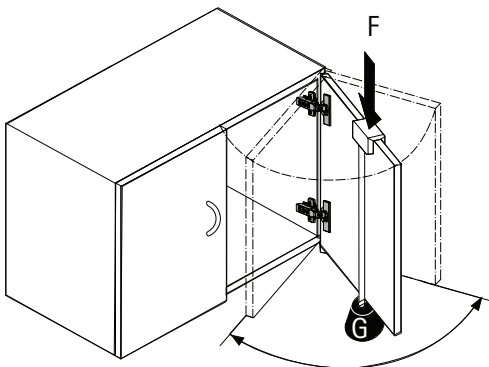

Closing test

The door is opened by 30° and pushed closed from this position by means of a pulley and falling weight.

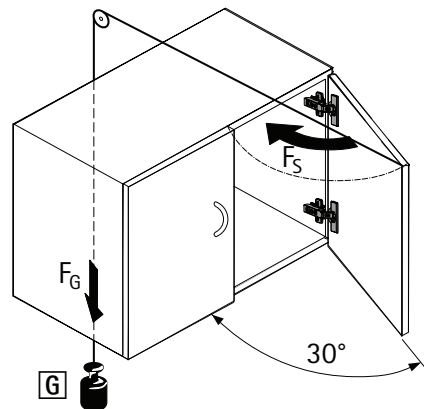

Horizontal test

The door is over opened with a defined test force F . (This test only applies to hinges with an opening angle $< 135^\circ$.)

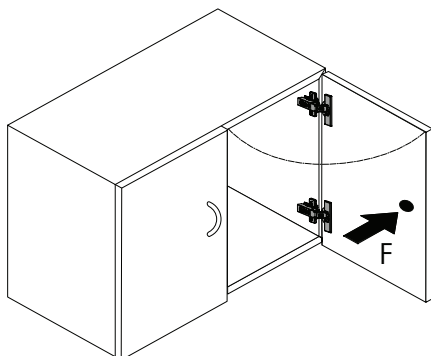

Vertical test

The door is subjected to a specific number of opening and closing cycles under a defined additional load G .

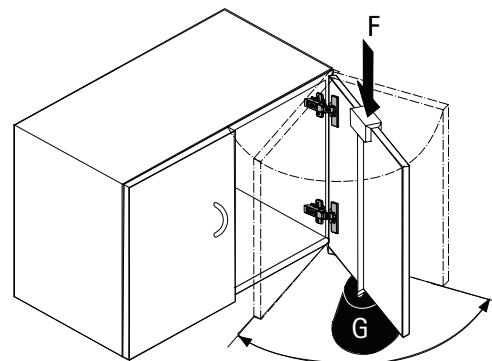

We are improving our environmental performance – as proven by EMAS, the world's most stringent environmental management system.



Our corporate principles include taking responsibility for preserving the natural basis of life. This is where we regard statutory provisions as minimum requirements. Over and above meeting statutory requirements, it is imperative for all members of staff to act in a way that conserves energy and resources in their own particular work environment in order to overcome the global ecological challenges of the near future. In the same way, using energy and resources efficiently also plays a key part in maintaining our competitive edge.

The group wide Environmental Department was established back in 1992, with its sustainability principles of environmental protection and occupational health and safety having consistently set the framework for leading the company group forward in this direction since 1993. Introduced in 1996, the environmental management systems complying with the European EMAS Regulation (Eco Management and Audit Scheme), including ISO 14.001, are of central importance in this context. These implemented a targeted approach to identifying and realising the potentials for using energy and resources in an efficient manner as well as to ensuring conformity with the law. The results are nothing short of impressive.

Environmentally friendly projects

Innovative projects are the mark of our approach to environmental management. For instance, the primary-energy requirement of our new production facilities is up to 75% below the specifications demanded in building legislation. The exemplary, consistent use of wood-based materials in constructing our commercial buildings puts us on the forefront of using resource-conserving, renewable building materials that take enormous quantities of climate-damaging CO₂ out of the atmosphere while they are growing.

Since 2015, we have been trying out three new vehicles, each employing different propulsion systems, to test the practical suitability of electric mobility in a variety of usage situations. At our Indian production plant, heavy metals are absorbed from concentrated waste water using an innovative method that involves living algae. At our factory in China, a solar-powered system provides staff accommodation and the canteen with hot water.

Success stories

Between 1997 and 2015, for example, we have managed to reduce environmental pollution from manufacturing our drawer runners and drawer systems at the Kirchlengern-Bünde production facility as follows:

- ▶ **Specific water consumption** 45 %
- ▶ **Specific power consumption** 10 %
- ▶ **Specific heat consumption** 73 %
- ▶ **Specific CO₂ emission** 30 %

Numerous awards reflect our commitment to the environment. In 2009, the European Commission gave our zero-energy Hettich Forum building the Green Building Award at national level. In 2016, we won the sustainability prize from the East Westphalian Business Environment Foundation for an environment education project carried out over 20 years.

Technik für Möbel



www.hettich.com

Order no. 9 262 533
1806-011_Sensys_1118_HON/en

INTERFER

Technik für Möbel

Hettich